







THIS DRAWING IS THE PROPERTY OF THE DESIGN ASSOCIATES INC. AND SHALL NOT BE COPIED OR USED IN ANY MANNER WITHOUT PRIOR PERMISSION.

**ELECTRICAL LEGEND :-**

SYMBOL	DESCRIPTION
	SWITCH BOARD
	TWO WAY SWITCH BOARD
	EM-TWO WAY SWITCH BOARD
	(1x18WATT) CFL LIGHT
	(1x18WATT) CFL EMERGENCY LIGHT
	CEILING FAN
	(1x15W) MIRROR LIGHT (LED)
	BRACKET LIGHT
	1x20W BULK HEAD LIGHT
	6A SWITCH SOCKET
	6/16A 5PIN SWITCH SOCKET
	CCTV
	6A SOCKET FOR CCTV
	LV JUNCTION BOX
	DISTRIBUTION BOARD
	25MM² CONDUIT FOR LIGHT
	25MM² CONDUIT FOR EMERGENCY
	25MM² CONDUIT FOR POWER
	25MM² CONDUIT FOR UPS
	25MM² CONDUIT FOR LV

NO. OF PRINTS	DATE	ISSUED TO	REMARKS
REVISION	DATE	DESCRIPTION	BY
R0	28.11.2017	FOR APPROVAL	NIKHIL TYAGI
R1	02.01.2018	FOR APPROVAL	NIKHIL TYAGI
R2	31.01.2018	FOR APPROVAL	NIKHIL TYAGI
R3	21.05.2018	FOR APPROVAL	NIKHIL TYAGI
R4	04.10.2019	FOR APPROVAL	BUNTY

ASSOCIATE ARCHITECTS-

**DESIGN ASSOCIATES INC.**  
ARCHITECTURE

A - 163, Sector - 136,  
Noida - Greater Noida Expressway,  
Noida - 201301  
Email: sachin.agarwal@designassociates.in

MECHANICAL CONSULTANT-  
ARK CONSULTANT, NEW DELHI

ELECTRICAL CONSULTANT-  
ARK CONSULTANT, NEW DELHI

PLUMBING CONSULTANT-  
ARK CONSULTANT, NEW DELHI

STRUCTURE CONSULTANT-  
CE CON ENGG., NEW DELHI

PROJECT-

**COMMERCIAL COMPLEX  
AT POLO MARKET  
SHILLONG**

DRAWING TITLE-

**SECOND FLOOR PLAN  
LIGHTING LAYOUT**

DRAWING PURPOSE-

**FOR TENDER PURPOSES ONLY**

JOB NO. - -----	DWG. REF. NO. - -----	DATE - 29-12-2017
SCALE - 1:150	REVISION - R4	DATE OF ISSUE - 04.10.2019

DWG. NO. - EL-109

	SHEET SIZE - A1	SHEET NO. - -----
	DRAWN BY - BUNTY	CHECKED BY - PANKAJ

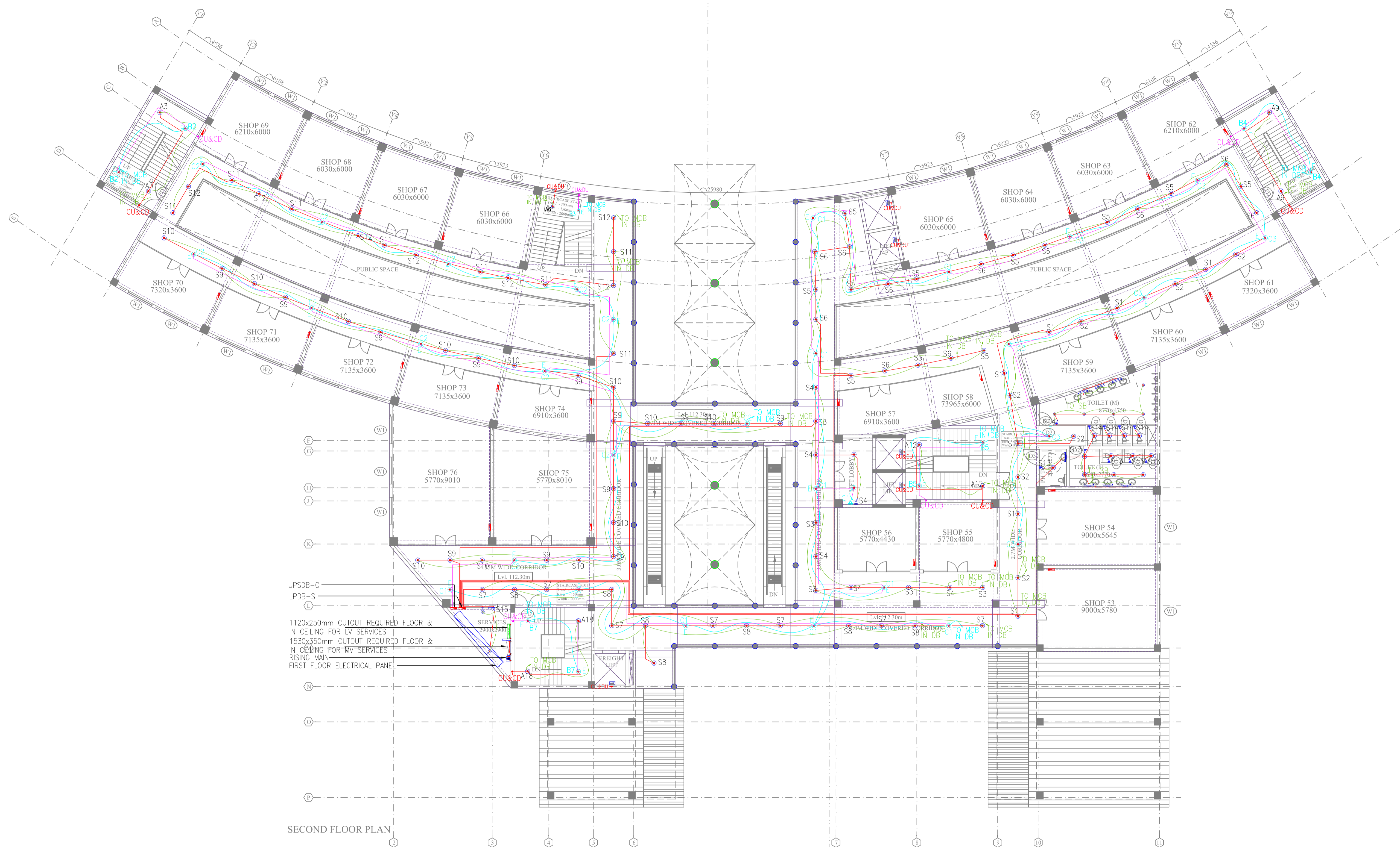

SECOND FLOOR PLAN

**NOTES FOR ELECTRICAL**

1. THE SIZE OF WIRES FROM SWITCH BOARD TO DIFFERENT LIGHT AND FAN POINTS SHALL BE 1.5 SQ. M.M.
2. 5 AMP. PLUG SHALL BE CONNECTED TO THE LIGHTING CKT. OF THAT AREA.
3. THE CONDUITS USED FOR WIRING SHALL BE AS FOLLOWS :  
SAME CONDUIT.  
a) HEAVY DUTY (2 MM THICK) : IN R.C.C. SLAB  
b) MEDIUM DUTY (1.5 MM THICK) : IN BRICK WALL
4. NO TWO DIFFERENT PHASE CIRCUIT / WIRE SHALL RUN TOGETHER THROUGH
5. LIGHT AND POWER CIRCUIT SHALL BE DRAWN THROUGH SEPARATE CONDUIT.
6. WIRING SHALL BE CARRIED OUT AS PER COLOUR CODE i.e. R, Y, B PHASES AND BLACK - NEUTRAL AND GREEN - EARTH.
7. THE POSITION MENTIONED IN LEGEND IS BOTTOM OF SWITCH BOARD / OUTLETS.
8. 230MM THICK WALL REQUIRED FOR DB MOUNTING.



THIS DRAWING IS THE PROPERTY OF THE DESIGN ASSOCIATES INC. AND SHALL NOT BE COPIED OR USED IN ANY MANNER WITHOUT PRIOR PERMISSION.

**ELECTRICAL LEGEND :-**

SYMBOL	DESCRIPTION
	SWITCH BOARD
	TWO WAY SWITCH BOARD
	EM-TWO WAY SWITCH BOARD
	(1x18WATT) CFL LIGHT
	(1x18WATT) CFL EMERGENCY LIGHT
	CEILING FAN
	(1x15W) MIRROR LIGHT (LED)
	BRACKET LIGHT
	1x20W BULK HEAD LIGHT
	6A SWITCH SOCKET
	6/16A 5PIN SWITCH SOCKET
	CCTV
	6A SOCKET FOR CCTV
	LV JUNCTION BOX
	DISTRIBUTION BOARD
	25MMø CONDUIT FOR LIGHT
	25MMø CONDUIT FOR EMERGENCY
	25MMø CONDUIT FOR POWER
	25MMø CONDUIT FOR UPS
	25MMø CONDUIT FOR LV

NO. OF PRINTS	DATE	ISSUED TO	REMARKS
REVISION	DATE	DESCRIPTION	BY
R0	28.11.2017	FOR APPROVAL	NIKHIL TYAGI
R1	02.01.2018	FOR APPROVAL	NIKHIL TYAGI
R2	31.01.2018	FOR APPROVAL	NIKHIL TYAGI
R3	21.05.2018	FOR APPROVAL	NIKHIL TYAGI
R4	04.10.2019	FOR APPROVAL	BUNTY

ASSOCIATE ARCHITECTS-  
**DESIGN ASSOCIATES INC.**  
 ARCHITECTURE  
 A - 163, Sector - 136,  
 Noida - Greater Noida Expressway,  
 Noida - 201301  
 Email: sachin.agarwal@designassociates.in

MECHANICAL CONSULTANT-  
 ARK CONSULTANT, NEW DELHI

ELECTRICAL CONSULTANT-  
 ARK CONSULTANT, NEW DELHI

PLUMBING CONSULTANT-  
 ARK CONSULTANT, NEW DELHI

STRUCTURE CONSULTANT-  
 CE CON ENGG., NEW DELHI

PROJECT-  
**COMMERCIAL COMPLEX  
 AT POLO MARKET  
 SHILLONG**

DRAWING TITLE-  
**SECOND FLOOR PLAN  
 POWER & LV & UPS LAYOUT**

DRAWING PURPOSE-  
**FOR TENDER PURPOSES ONLY**

JOB NO. -	DWG. REF. NO. -	DATE -
-----	-----	29-12-2017
SCALE -	REVISION -	DATE OF ISSUE -
1:150	R4	04.10.2019

DWG. NO. - **EL-110**

	SHEET SIZE -	SHEET NO. -
	A1	-----
	DRAWN BY -	CHECKED BY -
	BUNTY	PANKAJ

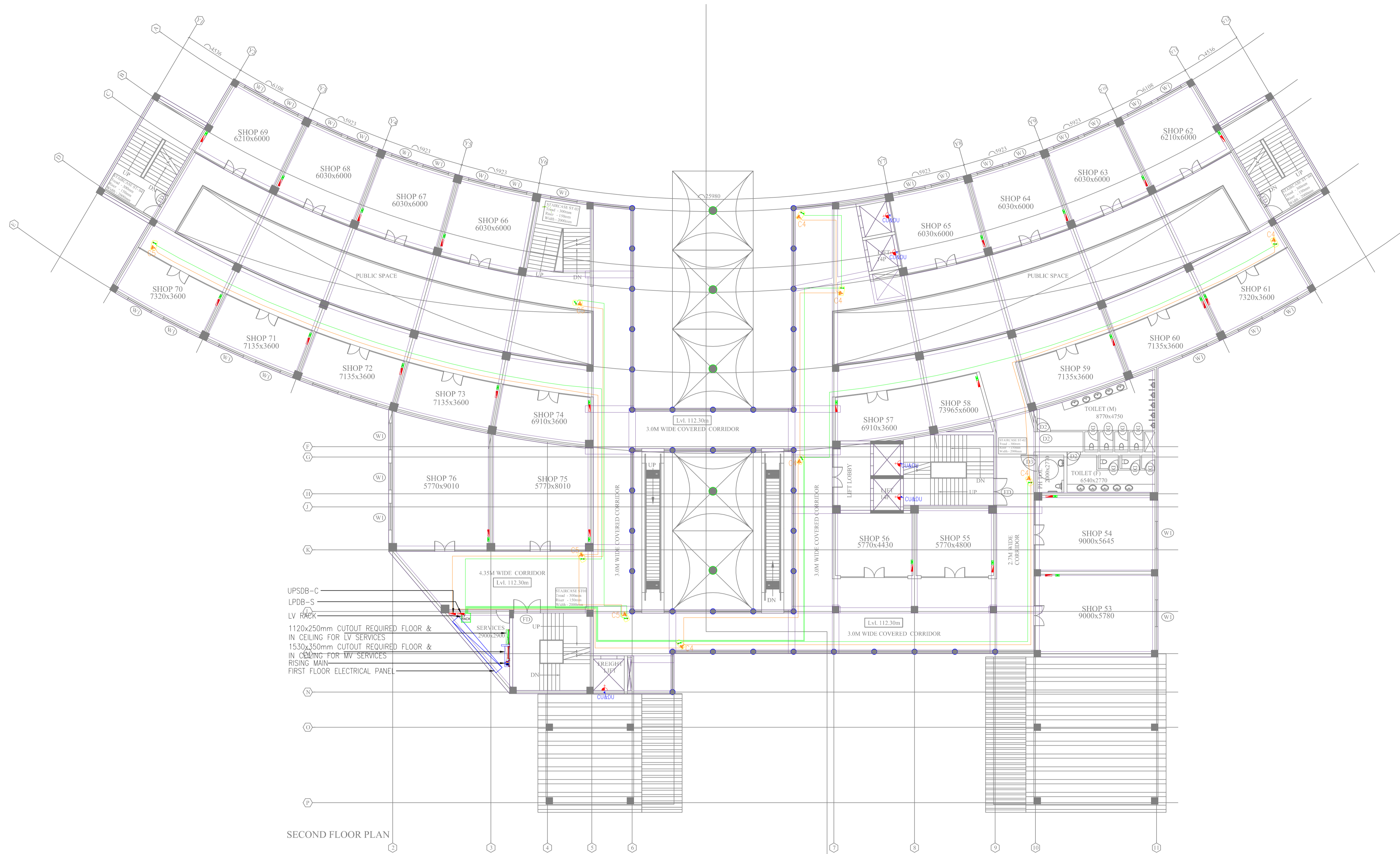

SECOND FLOOR PLAN

- NOTES FOR ELECTRICAL**
1. THE SIZE OF WIRES FROM SWITCH BOARD TO DIFFERENT LIGHT AND FAN POINTS SHALL BE 1.5 SQ. M.M.
  2. 5 AMP. PLUG SHALL BE CONNECTED TO THE LIGHTING CKT. OF THAT AREA.
  3. THE CONDUITS USED FOR WIRING SHALL BE AS FOLLOWS :  
 SAME CONDUIT.  
 a) HEAVY DUTY (2 MM THICK) : IN R.C.C. SLAB  
 b) MEDIUM DUTY (1.5 MM THICK) : IN BRICK WALL
  4. NO TWO DIFFERENT PHASE CIRCUIT / WIRE SHALL RUN TOGETHER THROUGH
  5. LIGHT AND POWER CIRCUIT SHALL BE DRAWN THROUGH SEPARATE CONDUIT.
  6. WIRING SHALL BE CARRIED OUT AS PER COLOUR CODE i.e. R, Y, B PHASES AND BLACK - NEUTRAL AND GREEN - EARTH.
  7. THE POSITION MENTIONED IN LEGEND IS BOTTOM OF SWITCH BOARD / OUTLETS.
  8. 230MM THICK WALL REQUIRED FOR DB MOUNTING.